

AS-122

Active Antenna Splitter 2 x 1 to 6

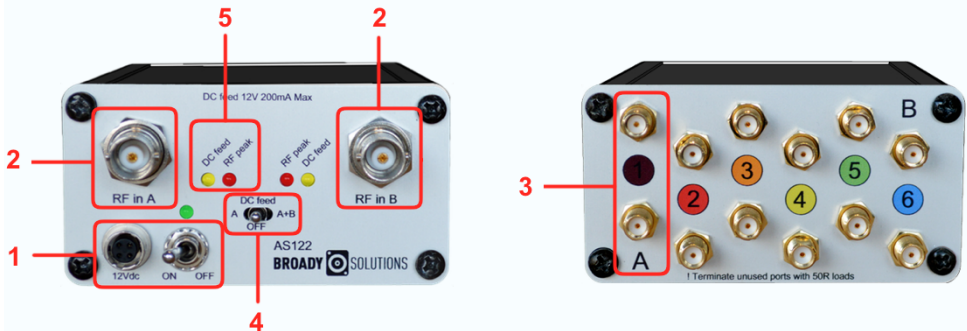

Instructions

- Power (1) : Switch ON/OFF to activate the unit
- RF in (2) : 50 ohms BNC inputs for reception antennas
Passive antennas up to 5m with RG58 and 10m with RG213
Active antennas with 15dB gain up to 35m with RG58 and 70m with RG213
- RF out (3) : SMA outputs to wireless receivers
Terminate unused ports with 50 ohms loads
- DC-feed (4) : Activate DC feed 12V/200mA (3 positions : Antenna A / OFF / Antennas A+B)

LED Indications (5)

- Power : Green color indicates that the device is on
- DC-feed : Orange color indicates that supply is enabled for active antennas. This orange LED will blink in case of short circuit in cable or connector
- RF Peak : This red LED lights up when RF level is too high. This may come from a wrong antenna booster setting or a transmitter too close from the antenna

Specifications

Bandwidth : 100MHz-900MHz
Gain : 0dB (+/- 1dB)
Noise figure : 1,5 dB
OIP3 : > 30dBm
Isolation : 15 dB
RF inputs : 2 BNC 50 ohms
Max. power input : 20dBm

RF Peak threshold : -8 dBm
DC feed : 12V/200mA (V DC feed = V In)
RF outputs : 2 x 6 SMA
Consumption : 150 mA without DC feed
Power supply : HRS4, 12-15V (1/2 - and 3/4 +)
Dimensions : 88 x 84 x 44mm
Weight : 265g

